



Verdala
INTERNATIONAL SCHOOL

NEW SCHOOL BUILDING

PROGRESS UPDATE III

- KINDERGARTEN
- ADMIN BUILDING
- PERFORMING ARTS SPACE
AND STUDIOS
- ROOF GARDEN

02 MAY 2024

Project Teams

2023-2024

Verdala Team

Totty Aris	Head of school
Nick Borg	Facilities Chair
Michael Anastasi	Project Architect / Structural Engineer
Joe Galea	Project Architect
Lisa Carson	Project Manager

M&E Team

Ing Joseph Vasallo	M&E Engineer	<i>Megaline</i>
Daniel Abela	Project Electrician	<i>Megaline</i>
Mark Fenech	Automation, Network installation & Design	<i>Future Habitats</i>

Fitout Contractor

Omar Caruana & Sena Deniz Halicioglu

Attard Bros





Verdala
INTERNATIONAL SCHOOL

New Facilities

The new block will contain the following;

- 2 Kindergarten classrooms with an indoor play area and associated facilities 140 sqm
- An independent Performing arts multi functioning space 115 sqm
- 1 music & drama studio, with back stage area and storage 105 sqm
- New Reception and administration area with 5 offices and meeting space 175 sqm
- Central foyer with facilities, storage and independent server room 75 sqm
- Roof garden & multipurpose teaching space - lift access 400 sqm

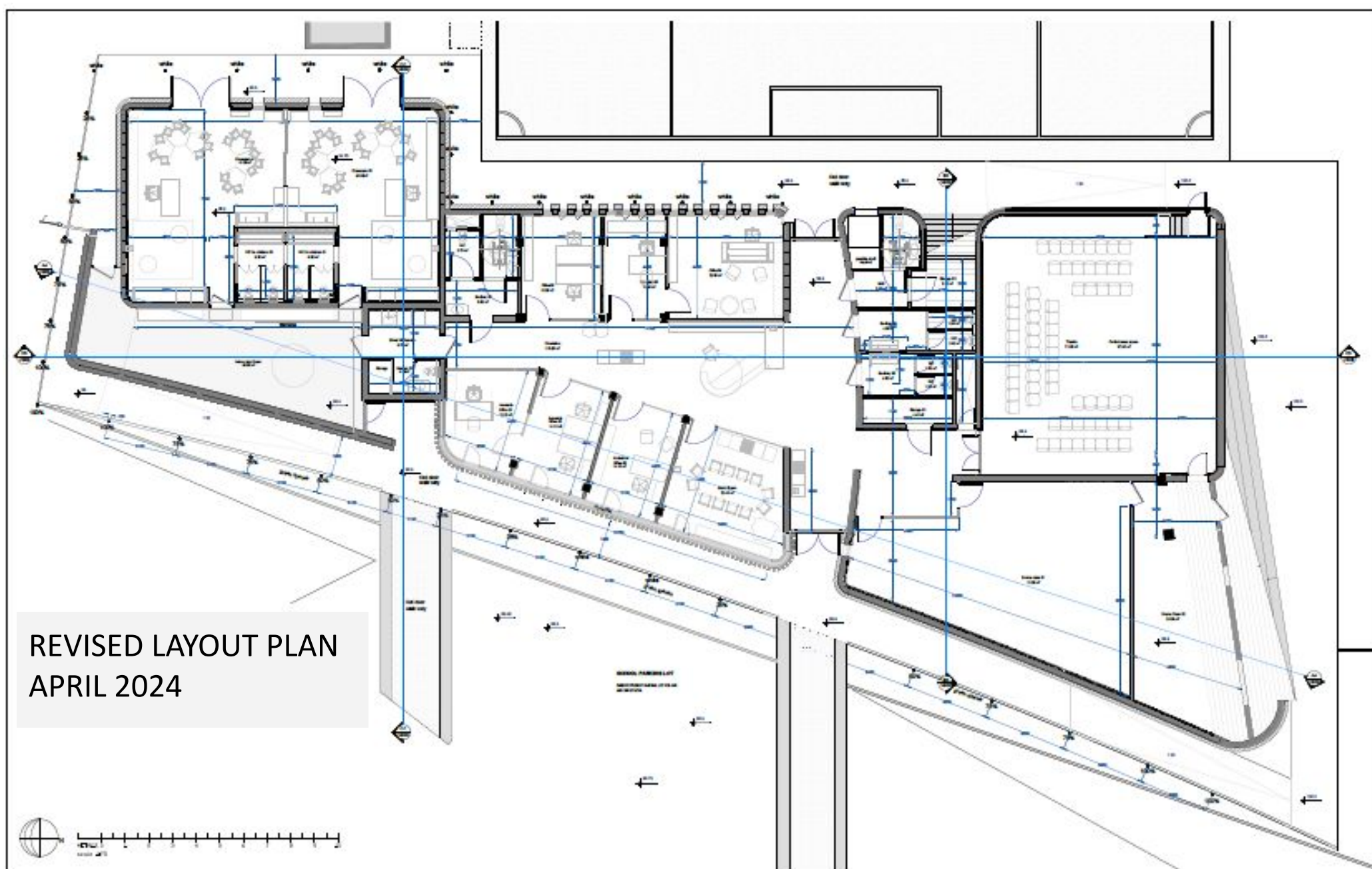

Verdala
INTERNATIONAL SCHOOL

2024 Timeline

APRIL 2024

Final amendments to the layout of drama studios and kindergarten

MAY 2024

Completion of shell form building - LC has provided finish date to builder

JULY 2024

Attard on site for full fitout
1st fix and apertures by end summer

AUG 2024

M&E testing
finalise install of fixtures and furnishings

SEPTEMBER

Interior finishes and fixed furniture
2nd/3rd fix

NOV/DEC 2024

Kindergarten fitout - snags and sign off

APRIL/MAY 2024

Concluding final costs based on this year costs and plans - begin initial works on site -pre planning & ordering of materials

JUNE 2024

M&E first fix based on new plans and network discussions
Attard working on site set up
Fire detection POW
COMMENCES

AUG/SEPT

M&E 2nd fix - all services
Exterior finishes and landscaping - entra
Prior to new school term

SEPT 2024

Admin and theatre fitout
supply final POW for end project to school board

**KINDERGARTEN
JAN 2025
OPEN !!!**



STAGE 1
CONCLUDE
NOV 24

STAGE 2
COMMENCE FF
DEC/JAN 24/25

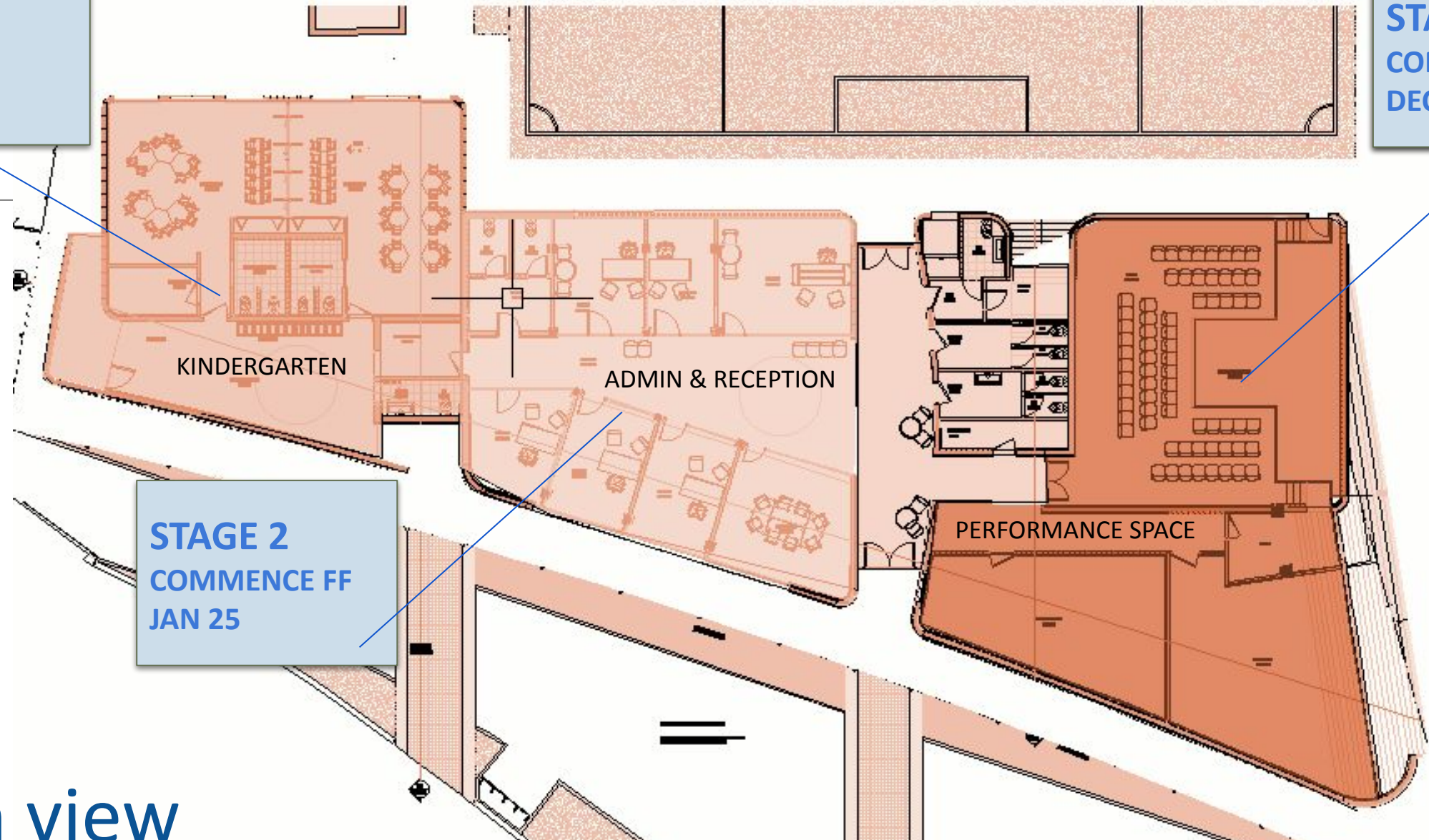

STAGE 2
COMMENCE FF
JAN 25

Plan view

ISSUES

ENEMALTA -Substation delays are being resolved - due for completion June 2024

REDESIGN - Delays have occurred as both architects have had to amend designs.
Layout changes occurred to reflect the school curriculum direction and needs as of 2024

CONSTRUCTION - Delays have occurred due to issues with Builder and Financial arrangements

M&E plans - Currently redesigning the M&Es layouts to suit chosen technology and updated services we will be using throughout the New build

PV PANEL LAYOUT

SERVICES AREA REDESIGN

